

# JTCC

MODEL: JL-9120L

## INSTRUCTION MANUAL RECHARGEABLE LED LANTERN

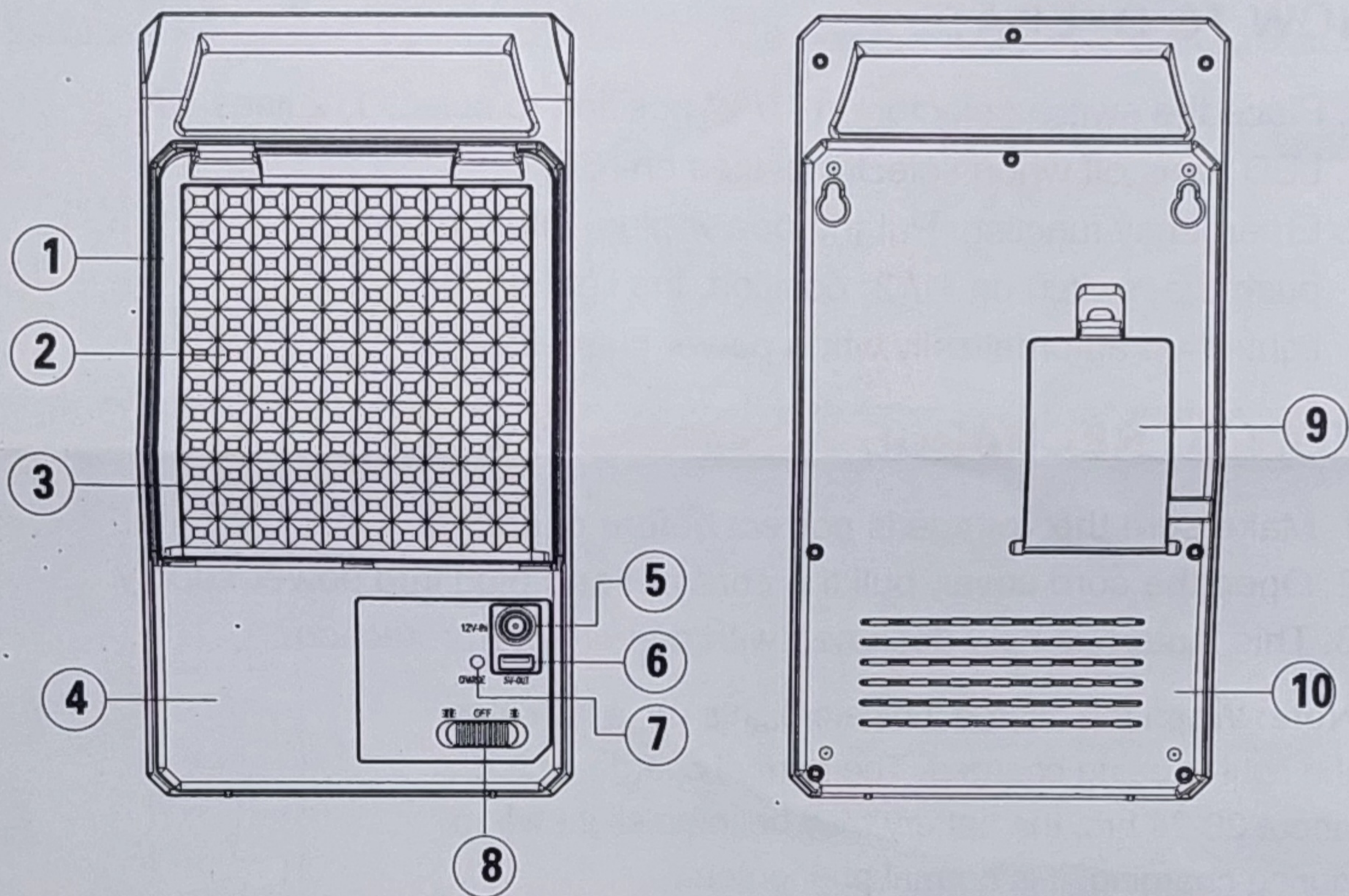

- 1. TRANSPARENT COVER
- 2. LED
- 3. REFLECTER
- 4. FRONT COVER
- 5. DC SOCKET

- 6. USB SOCKET
- 7. CHARGE INDICATOR
- 8. SWITCH
- 9. CORD COVER
- 10. BACK COVER

THANK YOU FOR USING OUR PRODUCT, PLS READ THE INSTRUCTION MANU CAREFULLY BEFORE INITIAL USE.



## IMPORTANT

1. Please read this manual carefully before first use with full charge.
2. Make sure the voltage is correct before plug-in.
3. Charge the lantern when light goes dim.
4. Charge the lantern for 8 hours at least every three months.
5. Turn off the switch when the lantern is not in use.
6. The efficiency may decrease if lantern is used or charged  
When temperature is below 32°F (0°C) or above  
104°F (40°C).
7. Keep out of water for proper use.

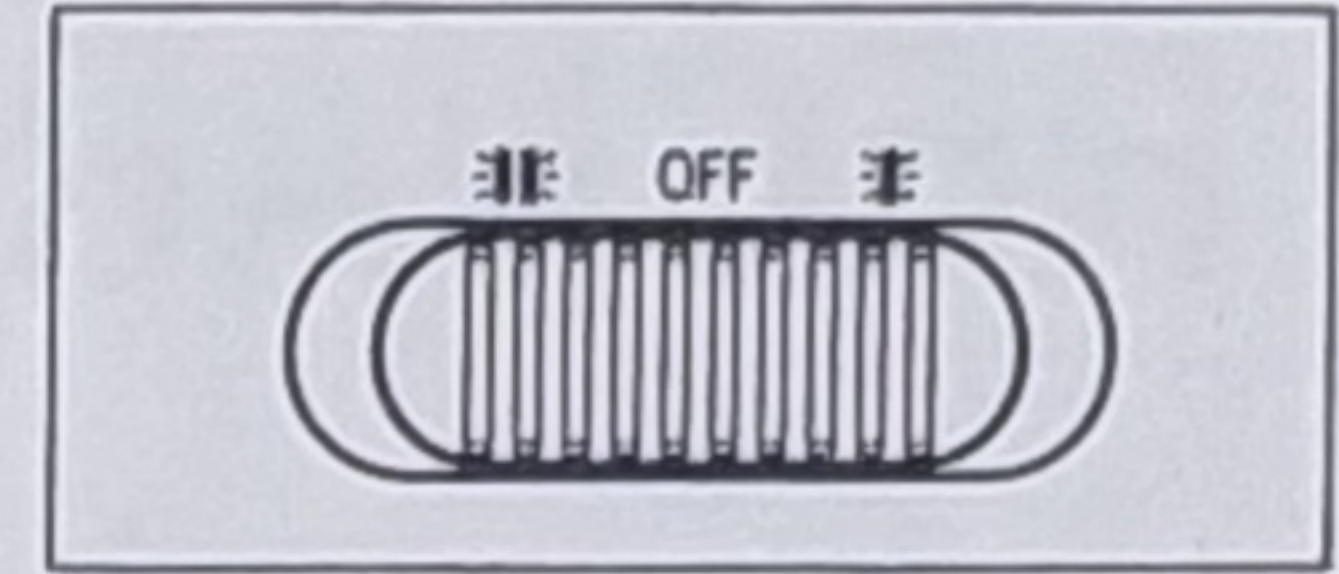

## HOW TO OPERATE

1. Place the switch selector on "1/ 2" position to select 1, 2 lines ON.  
LED turns off when selector places on "OFF".
2. Emergency function: Put the power plug into the socket,  
push the switch on "1/ 2" position, the light will be  
lighted up automatically when power cuts off.

## HOW TO RECHARGE

1. Make sure the voltage is correct before charging.
2. Open the cord cover, pull the cord out and plug into power supply.
3. This lantern is new designed with overcharge protection.

**Note:** When the charge indicator lights up, it indicates the light is being charged. The normal charge time is about 20-24 hrs, the battery may become slight warm during charging, it is normal phenomena.

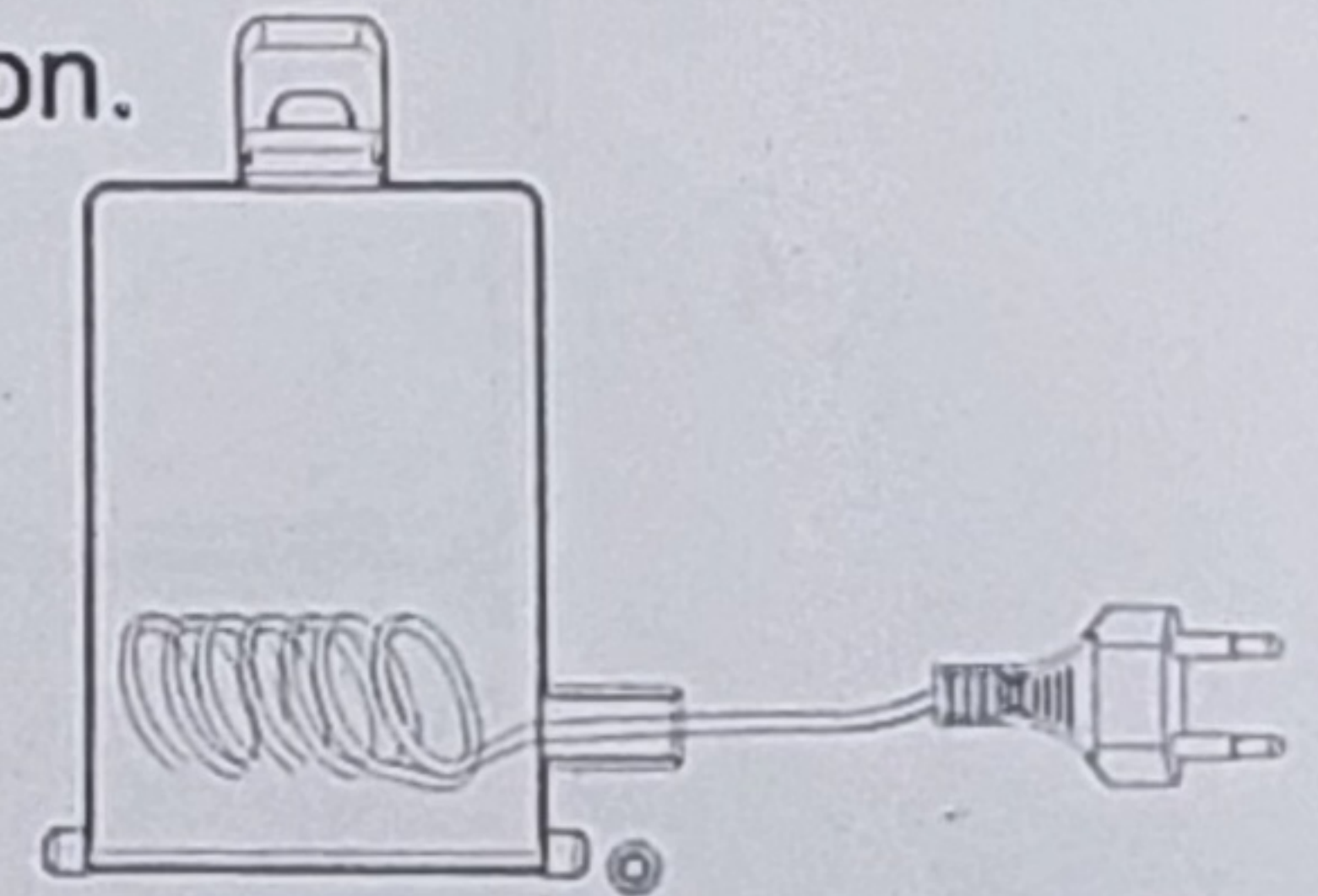

## SPECIFICATIONS

1. Power source: AC 220-240V 50/60Hz
2. Battery: 6V4.5Ah sealed lead-acid rechargeable battery
3. LED: 120 PCS SMD LED
4. Charge Time: 20~24 hours
5. Duration Time: 5 hours for strong light  
18 hours for weak light
6. Dimension: 165 X 65 X 300 mm