

OLFA®

CUTTING SOLUTIONS

HEAVY-DUTY RATCHET-LOCK UTILITY KNIFE

MODEL L-1

**RATCHET-BASED
LOCKING SYSTEM**

**TOUGH SILVER
SNAP BLADE**

**DURABLE
ABS BODY**

**STAINLESS-STEEL
SUPPORT CHANNEL**





DURABLE

- **Heavy-duty ABS Plastic** handle withstands drops and tough jobsite conditions
- **Classic pistol-grip** fits comfortably in hand



RELIABLE

- **Ratchet-based locking system** provides unlimited, secure cutting positions
- **Stainless-steel** support channel maintains blade position for heavy-duty cutting



AND ALWAYS SHARP

- Pre-loaded with **Tough Silver Snap-Off Blade**
- Simply **snap** for a fresh, **SHARP** edge



PRODUCT DETAILS

| SKU | MODEL | DESCRIPTION | PACKAGING | UPC |
|---|-------|--|---------------------------------------|-----------------|
| L-1 | 5003 | 18mm Heavy-Duty Snap-Off Utility Knife | CARD OF 1 | 0 91511 60004 9 |
| BLADE REFILLS Accepts any 18mm OLFA Blades (LB Silver, LBB ULTRA-SHARP Black, L-SOL Solid, LWB Serrated Edge, LFB ULTRA-SHARP Speed, and LH Hook) | | | HANDLE MATERIAL ABS PLASTIC | |

BLADE CHANGE INSTRUCTIONS

For all ratchet-wheel style knives including

Models: CL-1, H-1, L-1, L-2, L-5, MXP-L, NH-1, NOL-1, OL, XH-1, XL-2, 300

1

TURN RATCHET-WHEEL
DIAL COUNTER-
CLOCKWISE TO LOOSEN
LOCKING MECHANISM.

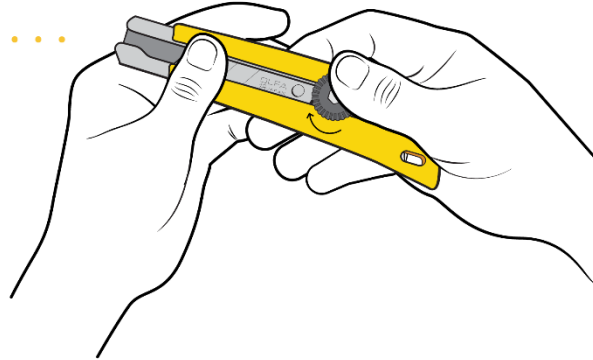

2

SLIDE RATCHET-WHEEL
ASSEMBLY PAST BASE OF
HANDLE TO REMOVE.

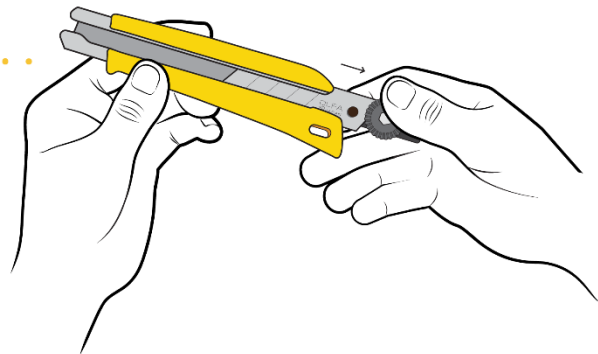

BLADE CHANGE INSTRUCTIONS

For all ratchet-wheel style knives including

Models: CL-1, H-1, L-1, L-2, L-5, MXP-L, NH-1, NOL-1, OL, XH-1, XL-2, 300

3

REMOVE RATCHET-WHEEL
DIAL FROM BLADE.
CAREFULLY SLIDE USED
BLADE SECTION OUT OF
HANDLE AND DISPOSE OF
PROPERLY IN SHARPS
CONTAINER.

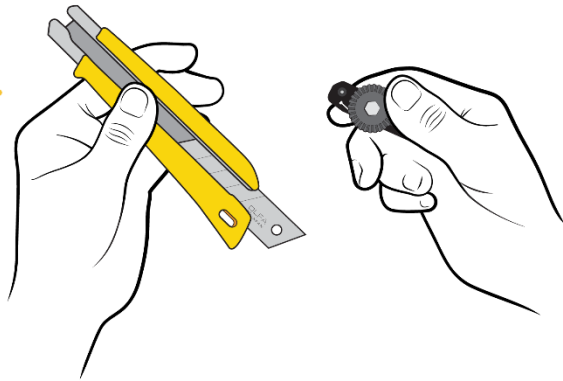

4

INSERT NEW BLADE
INTO CHANNEL. ALIGN
WITH ASSEMBLY BY
PLACING THE HOLE IN
THE BLADE OVER THE
RAISED MOUNTING
POINT.

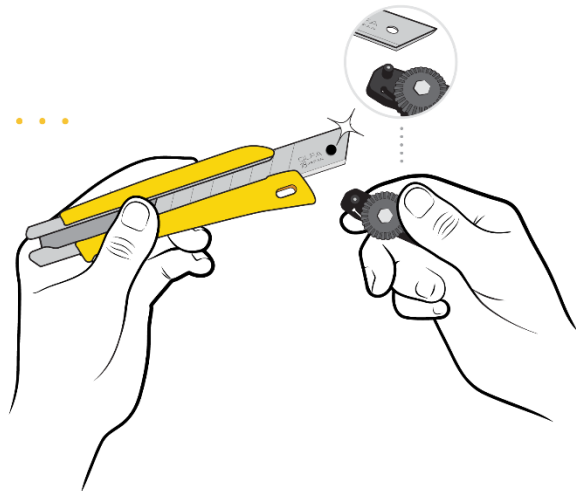

BLADE CHANGE INSTRUCTIONS

For all ratchet-wheel style knives including

Models: CL-1, H-1, L-1, L-2, L-5, MXP-L, NH-1, NOL-1, OL, XH-1, XL-2, 300

5

SLIDE RATCHET-WHEEL
ASSEMBLY AND BLADE
FORWARD.

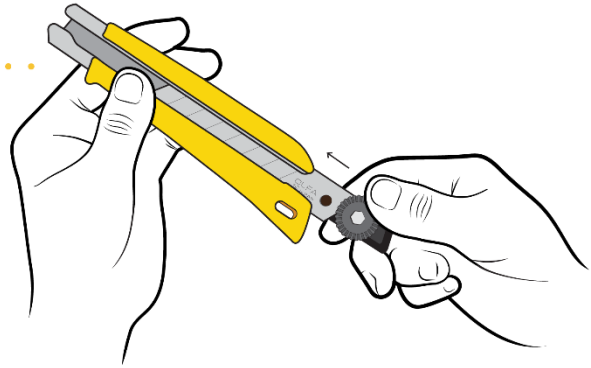

6

TURN RATCHET-WHEEL DIAL
CLOCKWISE TO TIGHTEN THE
LOCKING MECHANISM AND
RETURN TO WORK.

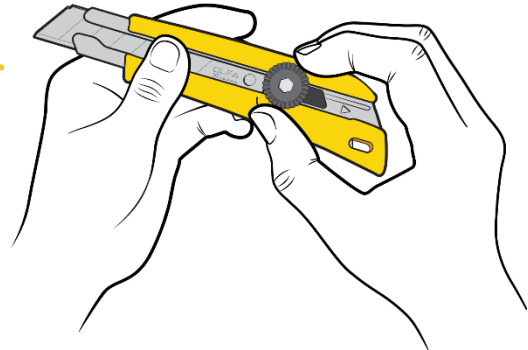



BLADE CHANGE INSTRUCTIONS

For all ratchet-wheel style knives including
Models: CL-1, H-1, L-1, L-2, L-5, MXP-L, NH-1, NOL-1, OL, XH-1, XL-2, 300

Videos:



How to SNAP a blade:

