



Arké: Classic plate 3M Reflex ice

19653.66

Arké / Cover plates / Reflex Classic cover plates

Classic plate 3M Reflex ice

3-module Classic cover plate, technopolymer, Reflex ice

Product Status

3 - Active

Minimum order quantity

10 NR



You may also be interested in



[19613 - Frame 3M +screws](#)

Video

- [Arké lives in your time](#)

Drawings

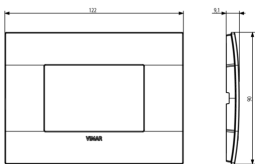

Space view

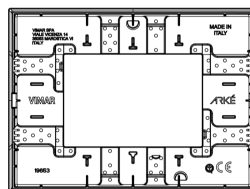

Backside view

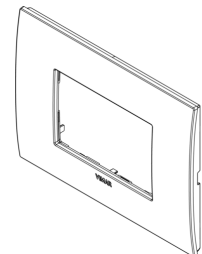

3D View

Gallery



Technical data

- **Class group:** Domestic switching devices
- **Class:** Cover frame for domestic switching devices
- **Number of units:** 3
- **Mounting direction:** Horizontal and vertical
- **Number of units horizontal:** 3
- **Number of units vertical:** 1
- **Number of modules horizontal (module system):** 3
- **Number of modules vertical (module system):** 1
- **Number of switch inserts:** 0
- **With mounting grid:** Yes
- **Suitable for floor box:** Yes
- **Suitable for wall duct:** Yes
- **Suitable for built-in installation:** Yes
- **Label space/information surface:** Yes
- **Material:** Plastic
- **Material quality:** Plastic glass
- **Halogen free:** Yes
- **Surface protection:** Untreated
- **Surface finishing:** Glossy
- **Colour:** White
- **RAL-number (similar):** 9016
- **Transparent:** No
- **With hinged lid:** No
- **Degree of protection (IP):** IP00
- **Type of fastening:** Clamp mounting
- **Width:** 122,00 mm
- **Height:** 90,00 mm
- **Depth:** 9,10 mm
- **Built-in width:** 122,00 mm
- **Built-in height:** 90,00 mm
- **Diameter bore hole (opening):** 0 mm

Certifications

- 00. CE Marking - EU
- 01. IMQ - Italy ([download](#))
- 29. QCERT - Colombia
- 37. Marking - Morocco
- 43. UKCA mark - Great Britain

Packaging



Code 8007352552289
Quantity 1 NR
Dim. 12.2x9x0.9 [cm]
Weight 38 [g]



Code 8007352552296
Quantity 10 NR
Dim. 14.1x9.8x9.9 [cm]
Weight 430.8 [g]



Code 8007352640559
Quantity 160 NR
Dim. 39x29.5x22 [cm]
Weight 7,626 [g]

Legal

Vimar reserves the right to change at any time and without notice the characteristics of the products reported. Installation should be carried out by qualified staff in compliance with the current regulations regarding the installation of electrical equipment in the country where the products are installed. For the terms of use of the information on the product info sheet see [Conditions of Use](#).